



EXTROL®

Hydronic Expansion Tanks: Horizontal AX Series ASME

175 PSIG Working Pressure

Construction

Shell	ASME Approved Steel
Diaphragm	Heavy Duty Butyl/EPDM
System Connection	NPTF ¹ Malleable Iron Center NPTM ² Malleable Iron Center NPTM ³ Malleable Iron Top Offset
Finish	Red Oxide Primer
Air Valve	Schrader Valve w/EPDM Seats
Factory Precharge	12 PSIG (.8 bar)

Application

- For use in closed, non-potable hydronic heating and chilled water systems.
- Designed to meet all ASME Code Section VIII, Division 1 standards.
- Available with optional sight glass and seismic restraints (saddles).
- Suitable in propylene glycol applications with mixtures up to 50%.

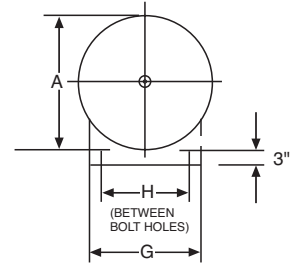

Performance

Maximum Operating Temperature	240°F (115°C)
Maximum Working Pressure	175 PSIG (12 bar)
Warranty	1 Year

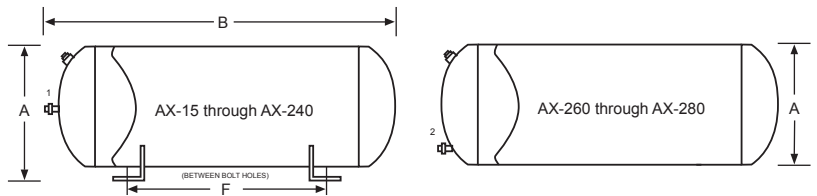

Horizontal ASME Models

Model Number	Tank Volume		Max. Accept. Volume		A Tank Diameter		B Tank Length		Sys. Conn	Restrains (Saddles) for Horizontal Mounting						Ship Wt. with Restrains (Saddles)		Shipping Weight	
	Gal	Lit	Gal	Lit	In	mm	In	mm		F		G		H		Lbs	Kg	Lbs	Kg
AX-15	8.0	30.3	2.4	9.1	12	305	19	489	1/2 ¹	14 ³ / ₈	365	10	254	8	203	54	24	48	22
AX-20	10.9	41.3	2.4	9.1	12	305	26	607	1/2 ¹	21 ¹ / ₈	537	10	254	8	203	66	30	60	27
AX-40	21.7	82.2	11.3	42.8	16	356	29	737	1/2 ¹	22	557	14	356	12	305	112	51	96	44
AX-60	33.6	127.2	11.3	42.8	16	356	43	1073	1/2 ¹	36 ¹ / ₈	918	14	356	12	305	141	64	125	57
AX-80	44.4	168.1	22.6	85.5	24	610	29	725	1 ¹	16 ¹ / ₈	429	20	508	18	457	220	100	200	91
AX-100	55.7	211.8	22.6	85.5	24	610	33	840	1 ¹	21 ¹ / ₂	546	20	508	18	457	247	112	227	103
AX-120	68.0	257.4	34.0	128.7	24	610	41	1051	1 ²	29 ¹ / ₂	749	20	508	18	457	286	130	266	121
AX-144	77.0	291.5	34.0	128.7	24	610	46	1170	1 ²	34 ³ / ₈	873	20	508	18	457	305	138	285	129
AX-180	90.0	340.7	34.0	128.7	24	610	54	1357	1 ²	41 ¹ / ₄	1060	20	508	18	457	321	146	301	137
AX-200	110.0	416.4	34.0	128.7	24	610	64	1624	1 ²	52 ¹ / ₄	1327	20	508	18	457	370	168	350	159
AX-240	132.0	500.0	46.0	174.0	30	762	51	1295	1 ²	35	889	24	610	22	559	547	248	522	237
AX-260	159.0	600.0	56.0	212.0	30	762	62	1581	1 ¹ / ₄ ³	44 ¹ / ₄	1124	24	610	22	559	597	271	572	269
AX-280	211.0	800.0	84.0	318.0	30	762	80	2032	1 ¹ / ₄ ³	62	1575	24	610	22	559	780	354	755	342

All dimensions and weights are approximate.

Job Name _____	Notes _____
Engineer _____	_____
Contractor _____	_____
P.O. No. _____	_____
Sales Rep. _____	_____
Model No. _____	_____

